

Auto-fill data

Auto-fill your Enterprise Vault data into web pages and mobile apps.

- [Auto-fill Overview](#)
- [Disable Browser Password Manager & Export Saved Passwords](#)
- [Browser Extension Options](#)
- [Auto-fill Logins](#)
- [Auto-fill for Cards and Identities](#)
- [Auto-fill for Custom Fields](#)
- [Using URIs in Auto-fills](#)
- [Auto-fill for iOS](#)
- [Auto-fill for Android](#)

Auto-fill Overview

Once **Installed**, the WALLIX **Browser extension** facilitates Auto-fill to webpage pages and mobile apps. The Browser Extension is currently **available** for **Chrome** and **Firefox**.

Browser Password Managers are generally considered less secure than dedicated solutions like WALLIX Enterprise Vault. **Before using the Browser Extension** it is advisable to **Disable Browser Password Manager & Export Saved Passwords**.

Items can be added to the Vault from a webpage using the Browser Extension on Desktop or mobile devices.

Logins, Card and Identities, and **Custom Fields** can be auto-filled to a Webpage using the Browser Extension from a Desktop computer. There are various options for **Using URIs in Auto-fills**.

A number of options are available for **auto-filling webpages and mobile apps** on **Android Devices** and **iOS Devices**.

Other options are available in the Browser Extension such as **Badge Counter, TOTP Copy after Auto-fill** or **Auto-fill for iframes**.

Disable Browser Password Manager & Export Saved Passwords

Chrome Browser

Type <chrome://password-manager/passwords> into the address bar.

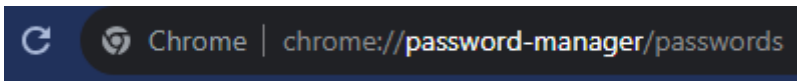

Click **Enter**. The **Passwords Screen** opens.

Click the Settings Link in the Password Manager menu. The Settings Screen opens.

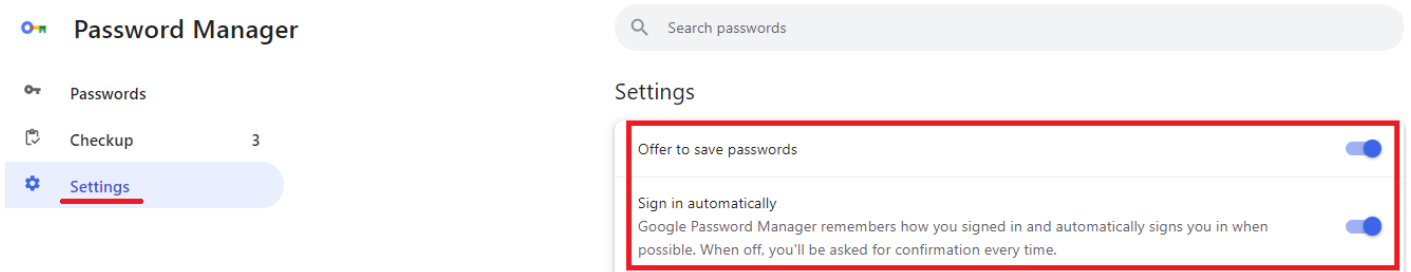

Disable Password Manager

Toggle off the following **options**:

- Offer to save passwords
- Sign in automatically

The Browser **no longer** offers to **save password** or **sign in automatically** to websites.

Export Saved Passwords

Click **Download file** beside the **Export passwords option**.

Export passwords

After you're done using the downloaded file, delete it so that others who use this device can't see your passwords.

[Download file](#)

The Passwords are exported in **CSV format**.

Firefox Browser

Type [about:preferences#privacy](#) into the address bar.

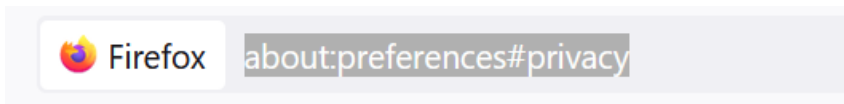

Click **Enter**. The **Passwords Screen** opens.

Logins and Passwords

- ☒ Ask to save logins and passwords for websites
- ☒ Autofill logins and passwords

Disable Password Manager

Toggle off the following **options**:

- Ask to save logins and passwords for websites
- Autofill logins and passwords

The Browser **no longer** offers to **save password** or **sign in automatically** to websites.

Export Saved Passwords

Click the **Saved Logins button** beside the Logins and Passwords options.

Logins and Passwords

- ☐ Ask to save logins and passwords for websites
- ☒ Autofill logins and passwords
- ☒ Suggest and generate strong passwords

Exceptions...

Saved Logins...

The Saved Passwords List is displayed.

Click the **three dots** link beside the Account name. The Context Menu is displayed.

Click the **Export Logins** Link.

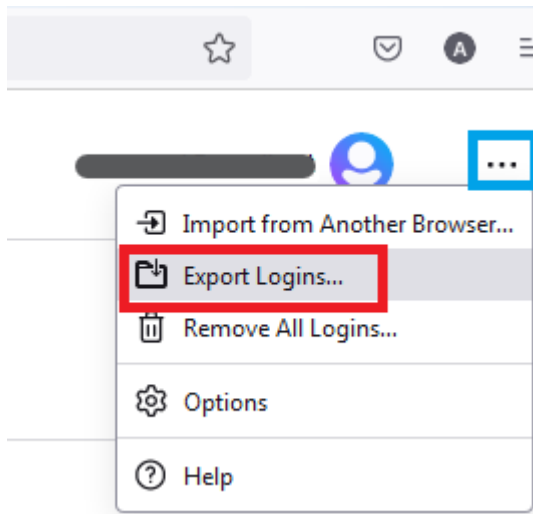

The Passwords are exported in **CSV format**.

Browser Extension Options

Badge Counter

The **Tab Screen** of the Browser Extension **automatically detects** the **URI** of the **currently displayed page**.

It finds any **Vault Items** that have the **same URI**.

It displays the **number of items found** for that page on the **Badge Counter icon**.

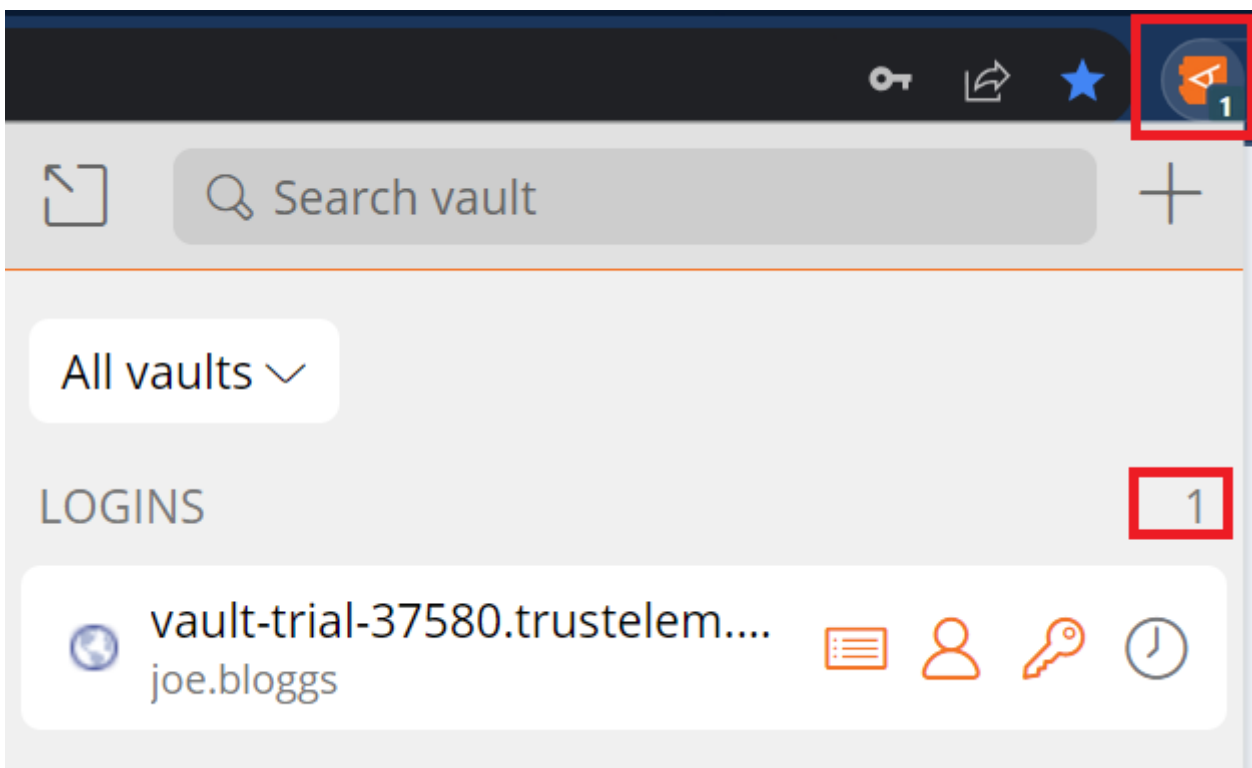

It is **turned on** by **default**.

It can be turned off by unchecking the **Show Badge Counter checkbox** in **Settings > Options**.

TOTP Copy after Auto-fill

If the Login uses **WALLIX Authenticator** for TOTP, the shortcut also **copies** the **TOTP** to the clipboard after auto-filling the web page with any of the above methods.

Auto-fill for iframes

Auto-fill does **not work** for untrusted iframes.

An untrusted iframe is **defined** as one where the **src** value is **not** the **same** as the **URI** for the **Login** item, as required in the rules set for **Match Detection Behavior**.

When the browser extension detects an iframe it responds based on the type of auto-fill being used:

- **Auto-fill on Page Load:** the browser extension disables the auto-fill on page load and does not warn the user
- **Auto-fill using Context menu, Keyboard Shortcut or from Browser Extension:** the browser extension warns the user about the iframe.

Auto-fill Logins

Prerequisite: The Browser Extension needs to be **installed** before the Auto-fill feature becomes available.

Auto-fill from Context Menu

Right click on the Login Screen of a website. The Context Menu is displayed.

Choose **WALLIX Vault > Auto-fill**.

If the Login is stored in the Vault, an Auto-fill option is proposed.

Click **Auto-fill** to **retrieve** the **Login** for this website to WALLIX Enterprise Vault.

If you are not signed in to WALLIX Enterprise Vault, you will be prompted to **sign in** before retrieving the Login.

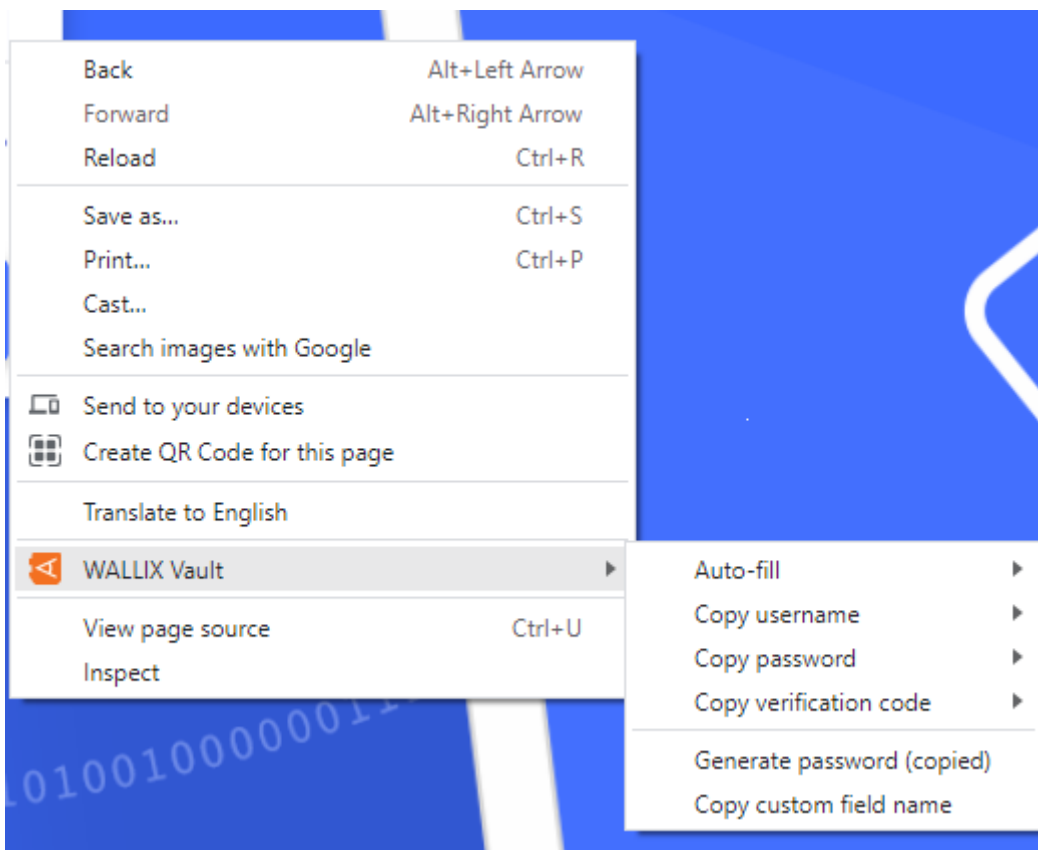

The context menu also contains other options for this Login:

- **Copy username:** copies the username of the login to the clipboard.
- **Copy password:** copies the password of the login to the clipboard.
- **Copy verification code:** copies the verification code of the login to the clipboard.
- **Generate password:** generates a new more secure password from the copied password.
- **Copy custom field name:** copies the name of the custom field of the login.

Auto-fill on Page Load

Auto-fill on Page load is a function that **automatically populates a Login** on a Page when the URI of the page being displayed corresponds to an Item in the Vault.

This is pertinent for **Logins, Cards or Identities**.

Untrusted iframes: Auto-fill on page load does **not work** for untrusted iframes.

HTTPS/HTTP: If the Vault Item **expects** an **HTTPS** site and a **HTTP** version of the site is **displayed**, the user is **warned before** auto-filling on page load.

Enable Auto-fill on page load

For **security reasons**, it is **automatically disabled** and needs to be enabled to work.

To **enable** Auto-fill on Page Load, from the Browser extension, navigate to **Settings> Autofill**. The Auto-fill screen opens.

Click the **Auto-fill on page load checkbox**. This **enables** the option to auto-fill logins on page load.

Auto-fill on page load



If a login form is detected, auto-fill when the web page loads.

WARNING: Compromised or untrusted websites can exploit auto-fill on page load. [Learn more about auto-fill.](#)

Default autofill setting for login items

Auto-fill on page load



You can turn off auto-fill on page load for individual login items from the item's Edit view.

Default URI match detection

Base domain



Choose the default way that URI match detection is handled for logins when performing actions such as auto-fill.

Auto-fill keyboard shortcut



The auto-fill shortcut is: Ctrl+Shift+L. Change this in the browser's settings.

From the **Default autofill setting for Login items dropdown**, choose the default option:

Default autofill setting for login items

Do not auto-fill on page load

Auto-fill on page load

Do not auto-fill on page load

This can be **overwritten** for each item from the **Items Screen**. This allows **specific auto-fill** options to be set for **specific items**.

From the **Default URI match detection dropdown**, choose how to match the URL of the webpage with the Login already in the Vault.

Default URI match detection

Base domain

Base domain

Host

Starts with

Regular expression

Exact

Never

Auto-fill Item to Vault on Page Load

If this **login** is **not** already **saved** in WALLIX Enterprise Vault, a **prompt** displays which **offers to save** the Login details for this Website.

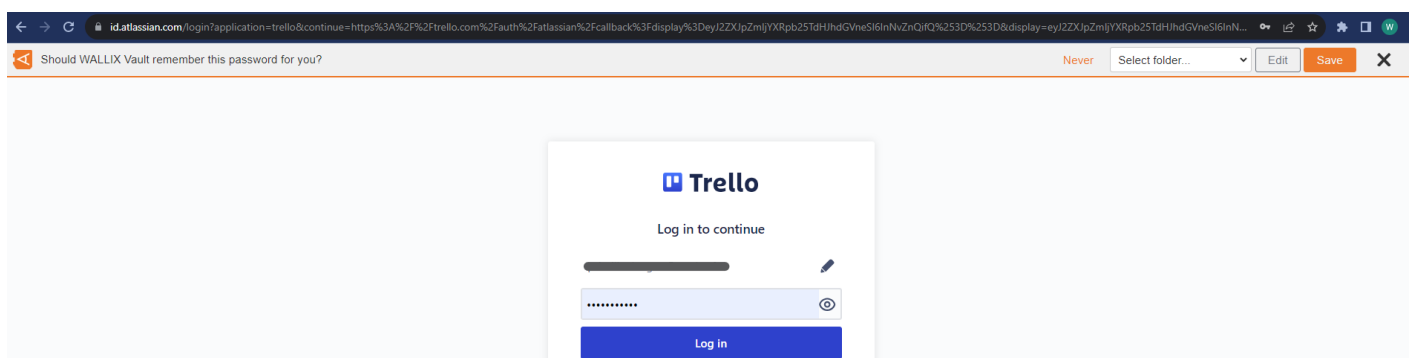

Choose a **Folder** to add the Login to this Folder in the Vault. This field is **optional**.

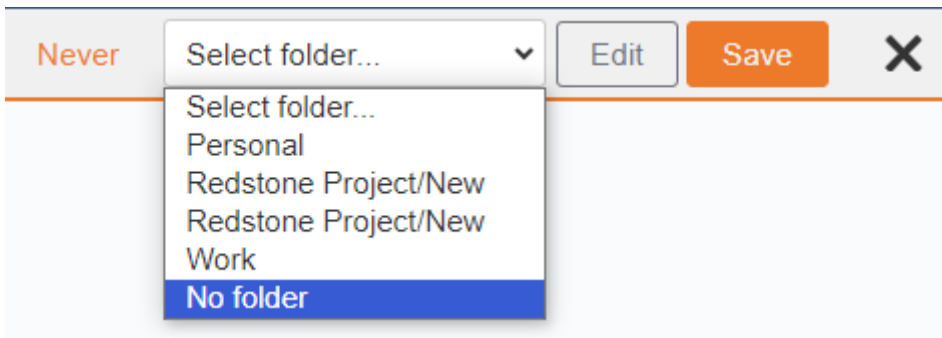
A screenshot of a user interface element. On the left, the word "Never" is displayed in orange. To its right is a dropdown menu with the text "Select folder..." and a downward arrow. The dropdown menu is open, showing a list of options: "Select folder...", "Personal", "Redstone Project/New", "Redstone Project/New Work", and "No folder". The "No folder" option is highlighted with a blue background. To the right of the dropdown are three buttons: "Edit" (light gray), "Save" (orange), and a close button represented by a black "X" icon.

Items are **added** to the **User's Individual Vault** and not a Shared Vault.

Click the **Save button**.

The **Add Item Screen** displays with the **fields pre populated** with the Login details.

Modify fields, if required.

Cancel

Add item

Save

ITEM INFORMATION

Type

Login

Name

id.atlassian.com

Username



Password

.....



Authenticator key (TOTP)



URI 1

https://id.atlassian.com/login?application=trello&contir



New URI

Auto-fill on page load (if set up in Options)

Use default setting



Folder

No folder



Favorite

☐

Master password re-prompt

☐

Notes

CUSTOM FIELDS

New custom field

Text

OWNERSHIP

Who owns this item?

Click **Save** to Save Item to Vault.

Alternatively, click **Cancel** to cancel the operation.

Auto-fill Manually

You can **manually add** a **Login** that is **not** already in the **Vault**.

From the **Vault Screen** of the **Browser Extension**, click **Add a login**.

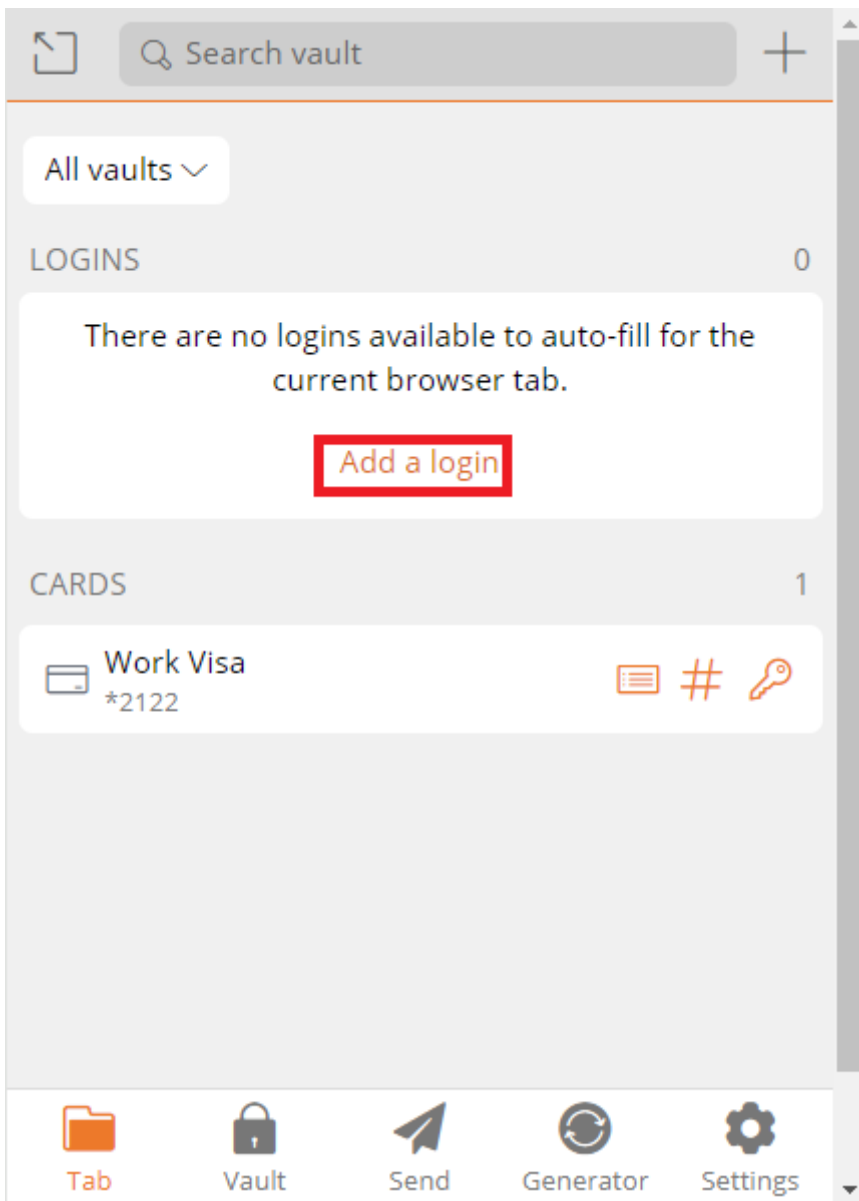

The **Add Item Screen** opens.

The **elements** that the Browser Extension could **recuperate** from the **browser** are **prepopulated**.

Cancel Add item Save

ITEM INFORMATION

Type
Login

Name
multimedia

Username

Password

Authenticator key (TOTP)

URI 1
https://multimedia

+ New URI

Auto-fill on page load (if set up in Options)

Enter the **remaining fields**. Click **Save** to create Login.

Alternatively, click **Cancel** to cancel the operation.

Auto-fill using Keyboard Shortcuts

Use the following **default keyboard shortcuts** (also known as **hot keys**) to auto-fill a login.

- Use Ctrl + Shift + L if running Windows or Linux
- Use Cmd + Shift + L if running for macOS

If **multiple logins** are found for the URI, the **last-used login** is used for auto-fill.

Keyboard shortcuts can be useful to **populating multiple logins** in **rapid succession**.

Configure shortcuts: If the keyboard shortcut doesn't work, it may be because **another app** is already **using it**. Either remove the shortcut from the other app or configure WALLIX to use a different shortcut.

TOTP Copy

If the Login uses **WALLIX Authenticator** for TOTP, the shortcut also **copies** the **TOTP** to the clipboard after auto-filling the web page with any of the above methods.

Auto-fill for iframes

Auto-fill does **not work** for untrusted iframes.

An untrusted iframe is **defined** as one where the **src** value is **not** the **same** as the **URI** for the **Login** item, as required in the rules set for **Match Detection Behavior**.

When the browser extension detects an iframe it responds based on the type of auto-fill being used:

- **Auto-fill on Page Load:** the browser extension disables the auto-fill on page load and does not warn the user
- **Auto-fill using Context menu, Keyboard Shortcut or from Browser Extension:** the browser extension warns the user about the iframe.

Auto-fill for Cards and Identities

Add to Vault

As for **Manually Adding Logins to the Vault**, **Cards** and **Identities** can be **auto-filled directly to the Vault** from the browser extension.

Click the **Add Item button** in the **Tab** Screen of the Browser extension.

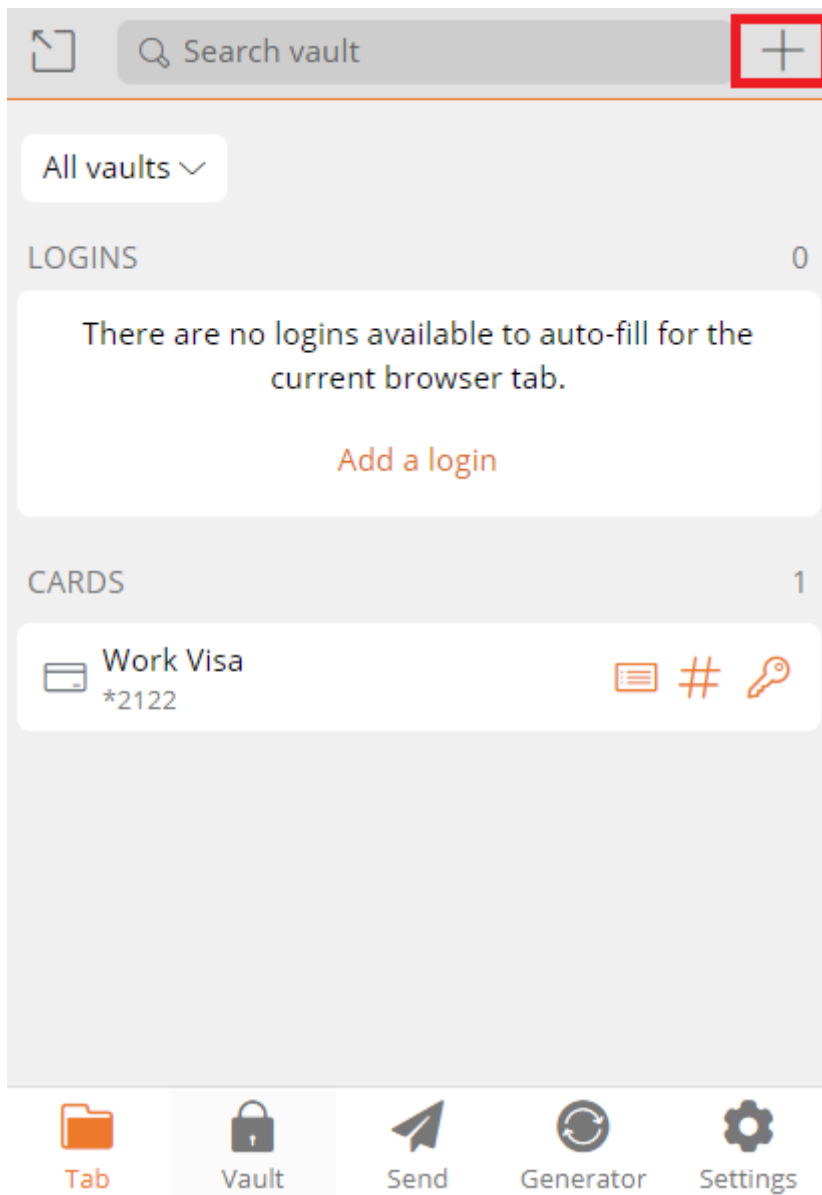

The Add Item Screen is displayed.

Choose **Type (Card or Identity)**.

Add rest of item details.

click **Save** to add item to Vault.

Alternatively, click **Cancel** to cancel the operation.

Auto-fill Manually

From an ecommerce website, navigate to the **add new card page**.

Open the **Browser Extension**.

The **Cards** saved in the Vault are **displayed**.

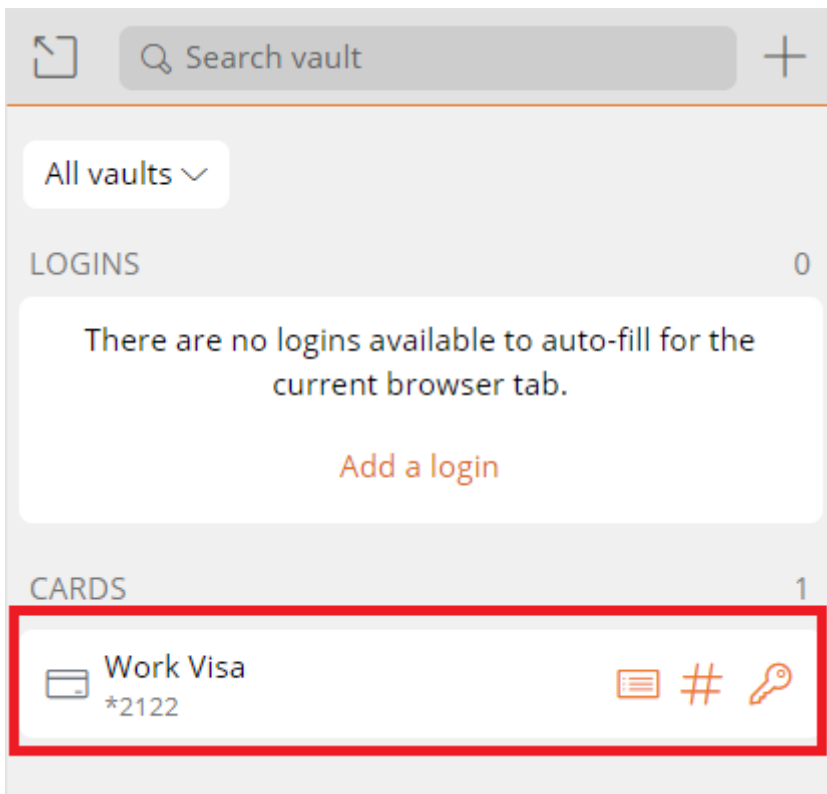

Click a **Card**. It will **automatically populate the webpage**.

The **procedure** is the **same** for populating an **identity** on a webpage.

Auto-fill using Context Menu

Cards and identities can be auto-filled to the Vault from the Context menu on the webpage.

This works the same as for **Logins**.

Hide Cards and Identities Option

Cards and Identities are displayed by default in the Tab Screen of the Browser Extension.

Uncheck the following options in **Settings > Options > Display** in the Browser Extension to **hide** these from **view**:

- **Show cards on Tab Page** checkbox
- **Show identities on Tab page** checkbox

∨ DISPLAY

Show cards on Tab page



List card items on the Tab page for easy auto-fill.

Show identities on Tab page



List identity items on the Tab page for easy auto-fill.

Auto-fill for Custom Fields

The **Browser Extension** can be used to **auto-fill a web page** with custom fields that have been added to Items. A typical application of this is for **PINs** and **Security Questions** that are often required in addition to a **Username** and **Password** to login to a website.

Auto-field Custom fields can be created for the **<form>** or **<input>** **elements**. A special scenario is possible for **** elements.

Auto-Fill Custom Fields

Open the **Browser Extension** on the **Webpage** that you wish to auto-fill.

The **Tab** Screen displays.

It **automatically detects** the **URI** of the webpage and **displays** any **logins stored** in the **Vault** that correspond with this URI.

Select the **Vault Item** that contains the **custom field** to be auto-filled to the webpage.



Your vault is locked. Verify your master password to continue.

Master password



Logged in as [redacted] or [redacted]
[redacted]@trustelem.com.

[Get master password hint](#)

Unlock

Log out

© 2023 WALLIX
Version 2023.9.1

Show all saved passwords

Emoji Win+Period

Undo Ctrl+Z

Redo Ctrl+Shift+Z

Cut Ctrl+X

Copy Ctrl+C

Paste Ctrl+V

Paste as plain text Ctrl+Shift+V

Select all Ctrl+A

Spell check ▶

Writing Direction ▶

Open in reading mode [New](#)

WALLIX Vault ▶

Inspect

Auto-fill

Copy username

Copy password

The Browser Extension finds any fields that **match** the **Custom field Name** and **auto-fill** that field's **value**.

For this reason it is **important** to **correctly name custom fields**.

Linked Custom Fields

Sometimes the Browser Extension is **unable to auto-fill usernames and passwords** for a webpage. In these cases, **Custom fields** can be created for the username and password and these can be used **instead** for auto-fill.

From the [Edit Item Screen](#), add a New **Custom Field** of type **Linked**.

[+](#) New custom field

Linked ▼

In the **Name** field, give it the same name as the **HTML form element** (id, name, aria-label, or placeholder) for the field in question.

This can be found by clicking the **Copy custom field name link** in the Context Menu of the field in question.

For **example**, to find the HTML form element for the Master Password in WALLIX Enterprise Vault, click the Copy custom field name link.

The HTML form element for the Master Password is **saved** to the **clipboard**.

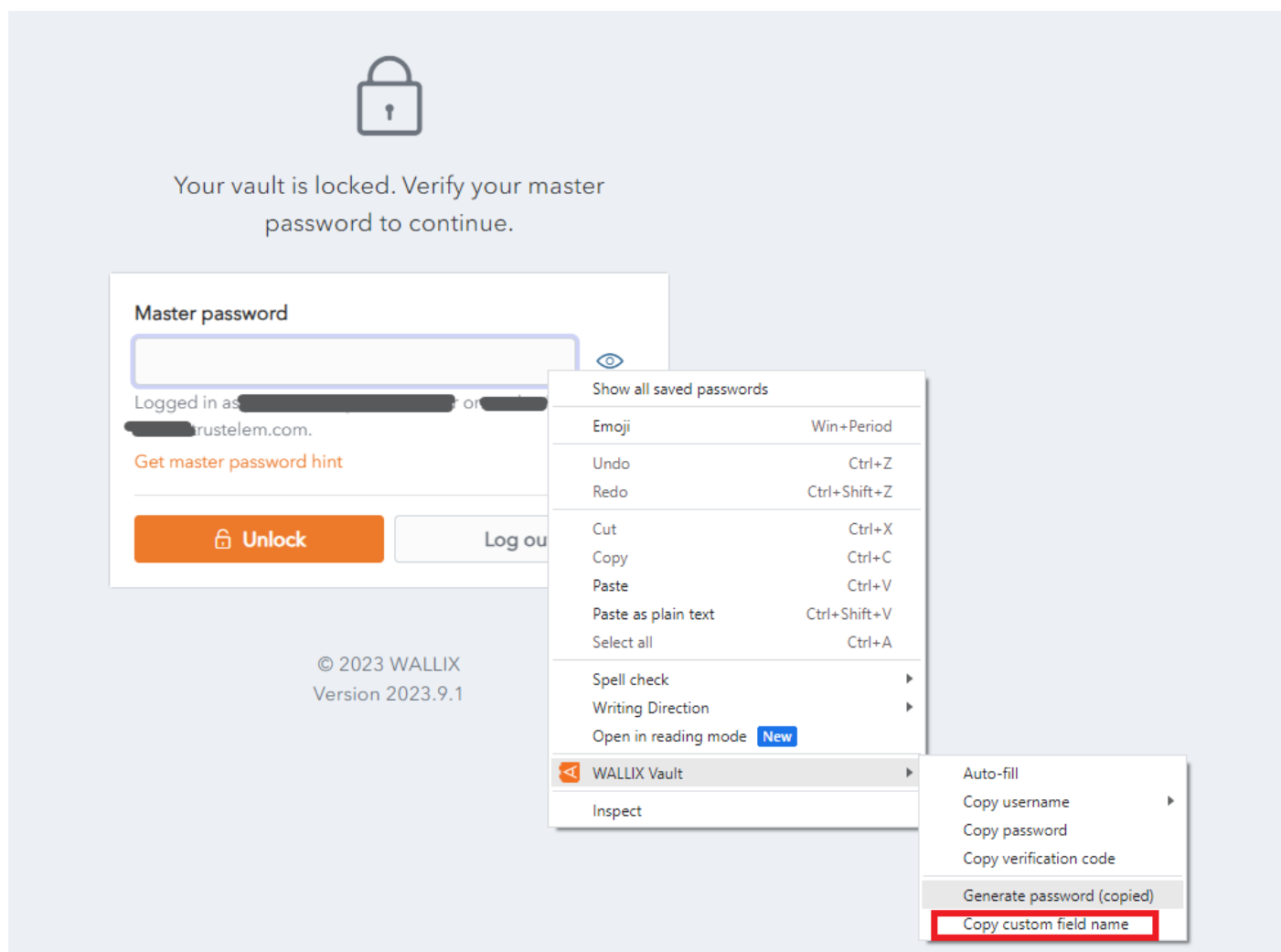

Paste the HTML Form element into the **name** field of the **custom field** that you are creating for Master Password.

CUSTOM FIELDS

Name

Value

masterPassword

Password



From the **Value** dropdown, select **Password** in the case of a **Custom field for password** (as in the example above) or **Username** in the case of a **Custom field for username**.

This procedure is valid for Auto-field Custom fields can be created for the **<form>** and **<input>** elements.

Auto-Fill for Span Tags

A **custom field** can be created for the **id** attribute of **** elements if the **data-bwautofill** attribute is **present** in the opening tag.



In the following **example**, you could create a Custom Field with the **name** of **title**. An **auto-fill** would **replace** the **contents** of **title** (currently "WALLIX Enterprise Vault" with the **contents** of the **custom field**.

```
<span data-bwautofill id="title">WALLIX Enterprise Vault</span>
```

Using URIs in Auto-fills

A **Login Item** can have **one or more URIs**. These are added from the **Create Item** or **Edit Item** Screen.

URI 1 Match detection

Default match detection 

 New URI

A **URI** is **defined** as a :

- Website address (URL)
- Server IP address
- Mobile App Package ID
- etc.

A **URI** is **mandatory** for a Login Item in order to **auto-fill** it into a web page.

URI Components

A **URI** is made up for a number of **components**.



`https://www.google.com:8080/calendar/item?id=123&type=task`

- **Scheme** `https://`
- **Hostname** `www.google.com`
 - **Subdomain** `www`
 - **SLD (second level domain)** `google`
 - **TLD (top level domain)** `com`
- **Port** `8080`
- **Path** `calendar/item`
- **Query String** `?id=123&type=task`

URI Scheme

A URI Scheme **should be specified** as part of the **URI**. If it is not specified **http://** is used by **default**.

However, if a Scheme is **not specified** by the user, the  **Launch button**, to launch the website or app directly from the Vault, will **not work**.

URI 1   Match detection
 

 New URI

Examples of schemes are

- https:// or http:// are schemes that reference web pages, e.g. https://www.google.com
- androidapp:// is a scheme that references an Android app package ID or name, e.g. androidapp://com.google.android

Mobile App URIs

Every mobile app has its **own URI**. In order to save the login of an app into the Vault, it is necessary to **save the URI** of the app.

Locate App URI for iOS

From the App Login Screen on your iOS device, **open the Browser Extension**.

Click the **+ button** to create a new Item in the Browser Extension.

The **New Item Screen** displays and it is **prepopulated** with the **URI** of the **App**.

This **only works if** the **App permits** recuperating the URI.

The Item can be **saved** as a **Login Item** for this Mobile App.

Alternatively, the **URI** can be **copied** and **pasted** into another Login Item.

Locate App URI for Android

From the **App page** in the **Google Play Store**, locate the **Share** button.

Copy the **Share Button link** to the clipboard.

Paste the link to an email or another file where it can be displayed.

The **link** will look something like this:

<https://play.google.com/store/apps/details?id=com.twitter.android>

The **URI** is the **id value**, in this example, com.twitter.android

URI Match Detection

Each URI associated with an Item in WALLIX Enterprise Vault has a number Match detection options in the that **Match detection dropdown** can be chosen.

The Match detection option chosen tells WALLIX **how to match the URI** of the **Vault Item** with the **URI** of the **web page or mobile app** for **auto-filling**.

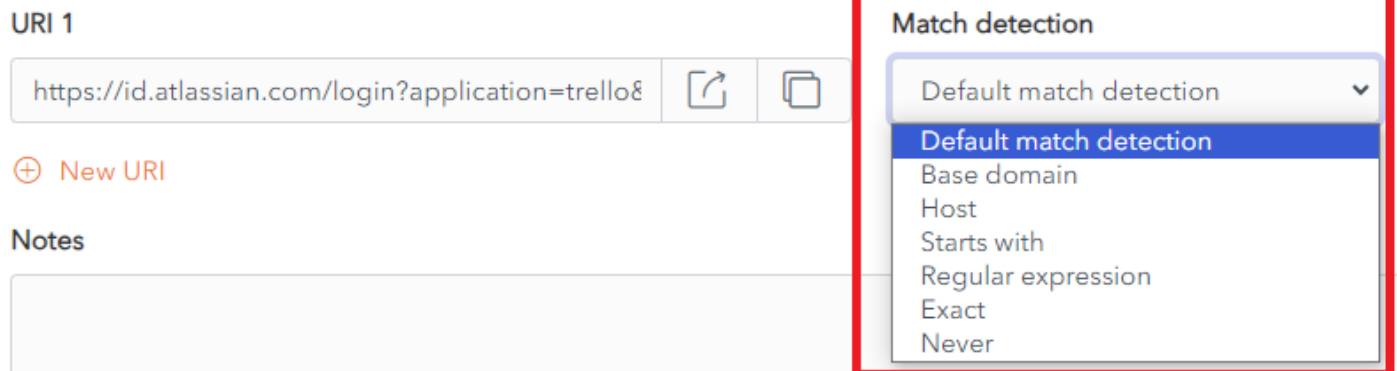

The screenshot shows the 'URI 1' field with the value 'https://id.atlassian.com/login?application=trello&'. Below it is a '+ New URI' button and a 'Notes' section. A red box highlights the 'Match detection' dropdown menu, which is open and shows the following options: 'Default match detection' (selected), 'Base domain', 'Host', 'Starts with', 'Regular expression', 'Exact', and 'Never'.

Default match detection

Base domain is the **default** option for **URI match detection**.

However, this can be **changed** in **Settings > Auto-fill** for **all Items**.

The Default match detection can be **specified** on a per item basis, in the Item Screen for **each item**. If not specified, the default option is used.

Base domain

If **Base domain** is chosen as the Default match detection for a URI, WALLIX will try to auto-fill all pages or apps where the **top-level domain (TLD) or second-level domain (SLD)** of the Page URI matches a the top-level domain or second-level domain of a Vault Item.

This works with **country code top level domains** only. Local TLDs, e.g. **www.google.local** do not work. **Local TLDs** work with **Host matching**.

For example,

https://google.com

Auto-fill works:

- www.google.com
- calendar.google.fr

Auto-fill does not work:

- www.google.net

Host

If **Host** is chosen as the Default match detection for a URI, WALLIX will try to auto-fill all pages or apps where the **hostname (and port, if specified)** of the Page URI matches a the hostname (and port, if specified) of a Vault Item.

For example,

https://calendar.google.com:8080

Auto-fill works:

- calendar.google.com:8080
- calendar.google.com:8080/home.html

Auto-fill does not work:

- www.google.com (different subdomain and missing port)
- www.google.com:8080 (different subdomain)
- calendar.google.com:8081 (different port)

Starts with

If **Starts with** is chosen as the Default match detection for a URI, WALLIX will try to auto-fill all pages or apps where the Page URI **starts with** the URI of a Vault Item.

For example,

https://www.google.com/home/

Auto-fill works:

- https://www.google.com/home/index.html
- https://www.google.com/home/

Auto-fill does not work:

- https://www.google.com
- https://www.google.com:8080/home/ (port number added)
- https://www.google.com/home (missing trailing slash)

Regular expression

If **Starts with** is chosen as the Default match detection for a URI, WALLIX will try to auto-fill all pages or apps where the Page URI matches a **specified regular expression** associated with the URI of a Vault Item.

Regular expressions are **case insensitive**.

For example,

```
^https://[a-z]+\google\.com/index\.php
```

Auto-fill works:

- `https://www.google.com/index.php`
- `https://fr.google.com/index.php`

Auto-fill does not work:

- `https://www.google.com/index/` (missing `.php`)
- `https://malicious-site.com?q=google.com`

For example,

```
^https://.*google\.com$
```

Auto-fill works:

- `https://www.google.com`
- `https://fr.google.com/index.html`
- **`https://malicious-site.com?q=google.com`**

URI matching with Regular Expressions is an **advanced** option and should **only** be used **by those familiar** with using **Regular Expressions**.

Periods (.) must be **escaped (\)** otherwise they will match on any character.

Auto-fill does not work:

- `https://google.com/index/` (missing period `.`)

Exact

If **Exact** is chosen as the Default match detection for a URI, WALLIX will try to auto-fill all pages or apps where the Page **URI** is an **exact match** for the URI of a Vault Item.

For example,

https://calendar.google.com/index.html

Auto-fill works:

- https://calendar.google.com/index.html

Auto-fill does not work:

- https://calendar.google.com/index.htm (index.htm instead of index.html)
- http://calendar.google.com/index.html (http instead of https)
- https://www.google.com/index.html (different subdomain)

For **HTTPS**, even if Exact matching is not used, the Browser Extension will **warn before** auto-filling a **HTTP** site if **HTTPS** is **expected**.

Never

If **Never** is chosen as the Default match detection for a URI, WALLIX will **never** try to **auto-fill** all pages or apps using **that Vault Item**.

Equivalent Domains

It is possible to link equivalent domains, or domains that use the same login.

For example, calendar.google.com can be linked with www.google.com.

This can be done in **Settings > Domain Rules**.

If **Exact match detection** is used an **equivalent domain** will **not** be **allowed**.

Auto-fill for iOS

Auto-fill is possible on an **iOS device** from your **Browser Extension** on **Chrome** or **Firefox** browsers.

Account Switching facilitates multiple logins at one time.

Auto-fill using Custom Fields is **not supported** on **mobile** devices.

Vault Timeout must be set to **Lock** (and not Log Out) **if NFC** is **required** for **Two-factor Authentication**.

Auto-fill using Keyboard

This is the **recommended** option.

Enable Auto-fill on Keyboard

From your **iOS device**, tap **Settings > Passwords > Password Options**.

The Autofill Passwords and Passkeys option is displayed.

Click **AutoFill Passwords and Passkeys** to **toggle** it **on**.

Click **WALLIX Vault** from the **Use Passwords and Passkeys From List**

[< Back](#) Password Options

AutoFill Passwords
and Passkeys



AutoFill helps you sign in to apps
and websites.

USE PASSWORDS AND
PASSKEYS FROM:



iCloud Passwords & Keychain



Chrome



Firefox



Google



WALLIX Vault



It is **recommended** that **other Auto-fill services** are **disabled**, like Chrome Password Manager or iCloud Passwords & Keychain.

Using Auto-fill on Keyboard

Open an **app or website** where you are **not logged into**.

Tap either the **Username** or **Password** Fields.

A Username or the Passwords button is displayed.

- If a **Username** is displayed, **tap** it. The Login is **auto-filled**.
- If the **Passwords** button is displayed, **tap** it. A **list of Logins** is displayed. **Choose** the **Saved Login** for this website. The Login is **auto-filled**.

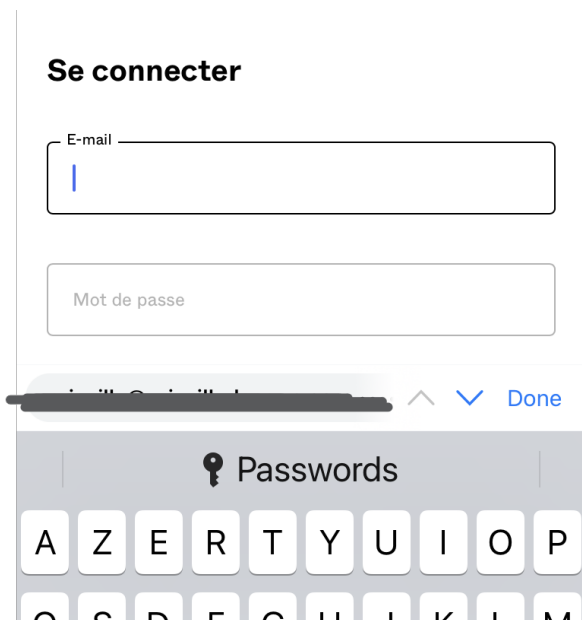

Where a **Passwords button** is displayed, it is likely because the website **URI isn't an exact match** on a URI associated with a Vault Item.

Auto-fill using Browser Extension

Enable Auto-fill in Browser Extension

From the **WALLIX Browser Extension App**, tap **Settings > Autofill > App Extension**

Tap **Enable App Extension button**.

A **Share Menu** slides up. Tap **WALLIX**.

Using Auto-fill in Browser Extension

Open an **app or website** where you are **not logged into**.

Tap the  **Share icon** in the Address Bar.

A Share menu is displayed.

Click the WALLIX Vault icon. A list of matching Logins is displayed.

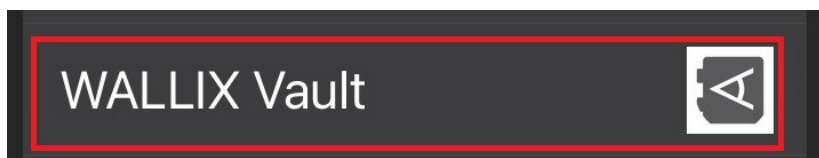

Choose the correct Login to auto-fill.

Auto-fill for Android

Auto-fill is possible on an **Android device** from your **Browser Extension** on **Chrome** or **Firefox** browsers.

Account Switching facilitates multiple logins at one time.

A number of **auto-fill options** are available, **depending** on the **version** of **Android** that your device is running.

- Auto-fill Service
- Inline Auto-fill
- Accessibility
- Draw-Over

Auto-fill using Custom Fields is **not supported** on **mobile** devices.

Vault Timeout must be set to **Lock** (and not Log Out) **if NFC** is **required** for **Two-factor Authentication**.

Auto-fill Service

This facilitates **Auto-Fill** from the **Login Screen**.

Auto-fill Service is **available** on **Android 8+**. It requires **enabling** of **Auto-fill Services**.

Enable Auto-fill Service

From WALLIX Android App, tap **Settings > Auto-fill > Auto-fill Services**

Tap **WALLIX** from the **Auto-fill Services List**.

Tap **Confirm**.

Using Auto-fill Service

Tap on **Username** or **Password** fields on a webpage or an app.

A **pop up screen** will display **2 options**:

- The **Matching Login Item** from WALLX Vault. Tapping on this option **auto-populates** the Login.
- **Auto-fill from WALLIX Vault**. Tapping on this option **opens** the **Vault** if the Vault is unlocked to **browse** the available **Login Items**.

If WALLIX Vault is **locked**, you will be **prompted** to **login** to your Vault.

Inline Auto-fill

This facilitates **Auto-Fill** from the **Keyboard Section**.

Inline Auto-fill: Available on Android 11+. It requires **enabling** of **Autofill Service** and Input Method Editor (**IME**).

If it **doesn't work**, it is **possible** that your **IME** does **not support inline**.

Enable Inline Auto-fill

From WALLIX Android App, tap **Settings > Auto-fill > Auto-fill Services**

Tap the **Use Inline Autofill** option to **toggle** it **on**.

Using Inline Auto-fill

Tap on **Username** or **Password** fields on a webpage or an app.

Logins matching the **URI** are displayed in the **keyboard section**.

Choose the **option** required.

It is **auto-filled** into your webpage or app.

Accessibility

This facilitates **Auto-Fill** from the **Login Screen**.

Draw-Over is **available** in **Android 6+**. It requires **Enabling** of **Accessibility** and **Drawover**

Enable Accessibility

From WALLIX Android App, tap **Settings > Auto-fill > Auto-fill Services**

Tap the **Use Accessibility** option to **toggle** it **on**.

Using Accessibility

Tap on **Username** or **Password** fields on a webpage or an app.

A **pop up screen** displays an option to **Auto-fill from WALLIX Vault**.

Tap on this **option**.

If the Vault is **unlocked**, the Vault is **opened**.

If WALLIX Vault is **locked**, you will be **prompted** to **login** to your Vault.

Drawover

This facilitates **Auto-Fill** from the **Login Screen**.

Accessibility is **available** on **all Android Versions**. It requires **Enabling** of **Accessibility**.

Enable Drawover

From WALLIX Android App, tap **Settings > Auto-fill > Auto-fill Services**

Tap the **Permit drawing over other apps** option to **toggle** it **on**.

Using Drawover

Tap on **Username** or **Password** fields on a webpage or an app.

A **pop up screen** displays an option to **Auto-fill from WALLIX Vault**.

Tap on this **option**.

If the Vault is **unlocked**, the Vault is **opened**.

If WALLIX Vault is **locked**, you will be **prompted** to **login** to your Vault.

