

Auto-fill Logins

Prerequisite: The Browser Extension needs to be **installed** before the Auto-fill feature becomes available.

Auto-fill from Context Menu

Right click on the Login Screen of a website. The Context Menu is displayed.

Choose **WALLIX Vault > Auto-fill**.

If the Login is stored in the Vault, an Auto-fill option is proposed.

Click **Auto-fill** to **retrieve** the **Login** for this website to WALLIX Enterprise Vault.

If you are not signed in to WALLIX Enterprise Vault, you will be prompted to **sign in** before retrieving the Login.

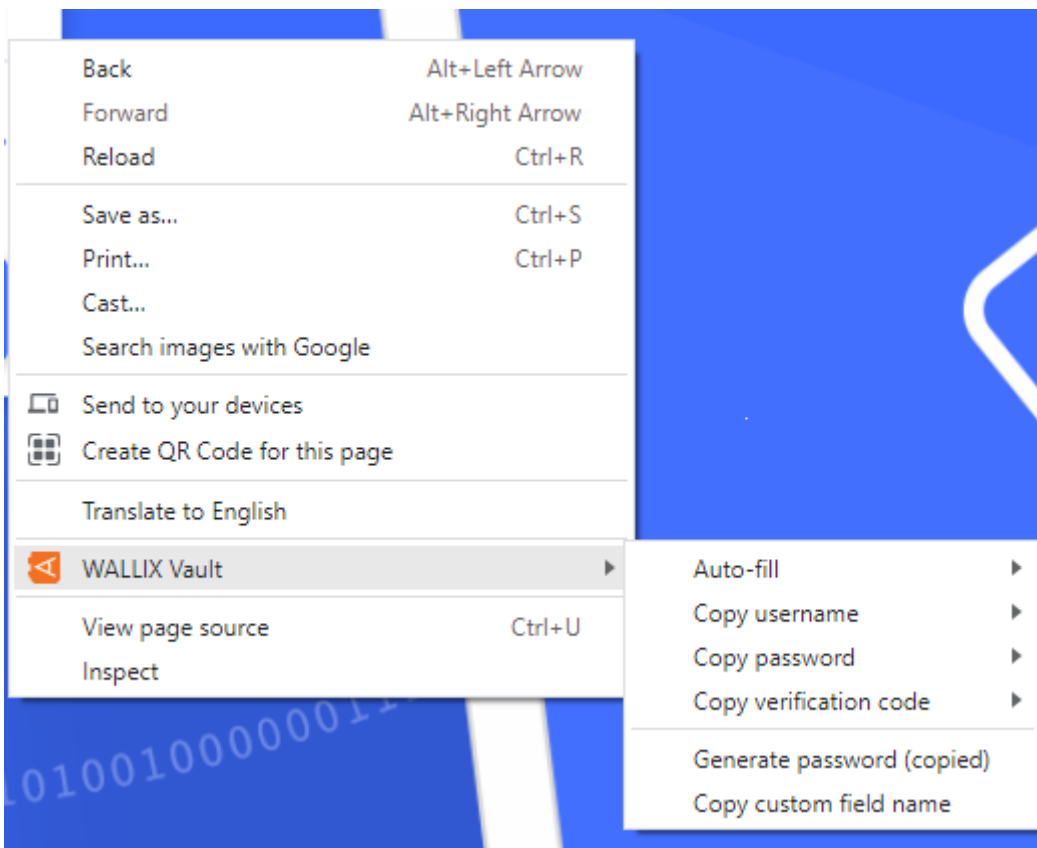

The context menu also contains other options for this Login:

- **Copy username:** copies the username of the login to the clipboard.
- **Copy password:** copies the password of the login to the clipboard.
- **Copy verification code:** copies the verification code of the login to the clipboard.
- **Generate password:** generates a new more secure password from the copied password.
- **Copy custom field name:** copies the name of the custom field of the login.

Auto-fill on Page Load

Auto-fill on Page load is a function that **automatically populates a Login** on a Page when the URI of the page being displayed corresponds to an Item in the Vault.

This is pertinent for **Logins, Cards or Identities**.

Untrusted iframes: Auto-fill on page load does **not work** for untrusted iframes.

HTTPS/HTTP: If the Vault Item **expects** an **HTTPS** site and a **HTTP** version of the site is **displayed**, the user is **warned before** auto-filling on page load.

Enable Auto-fill on page load

For **security reasons**, it is **automatically disabled** and needs to be enabled to work.

To **enable** Auto-fill on Page Load, from the Browser extension, navigate to **Settings> Autofill**. The Auto-fill screen opens.

Click the **Auto-fill on page load checkbox**. This **enables** the option to auto-fill logins on page load.

Auto-fill on page load



If a login form is detected, auto-fill when the web page loads.

WARNING: Compromised or untrusted websites can exploit auto-fill on page load. [Learn more about auto-fill.](#)

Default autofill setting for login items

Auto-fill on page load



You can turn off auto-fill on page load for individual login items from the item's Edit view.

Default URI match detection

Base domain



Choose the default way that URI match detection is handled for logins when performing actions such as auto-fill.

Auto-fill keyboard shortcut



The auto-fill shortcut is: Ctrl+Shift+L. Change this in the browser's settings.

From the **Default autofill setting for Login items dropdown**, choose the default option:

Default autofill setting for login items

Do not auto-fill on page load

Auto-fill on page load

Do not auto-fill on page load

This can be **overwritten** for each item from the **Items Screen**. This allows **specific auto-fill** options to be set for **specific items**.

From the **Default URI match detection dropdown**, choose how to match the URL of the webpage with the Login already in the Vault.

Default URI match detection

Base domain

Base domain

Host

Starts with

Regular expression

Exact

Never

Auto-fill Item to Vault on Page Load

If this **login** is **not** already **saved** in WALLIX Enterprise Vault, a **prompt** displays which **offers to save** the Login details for this Website.

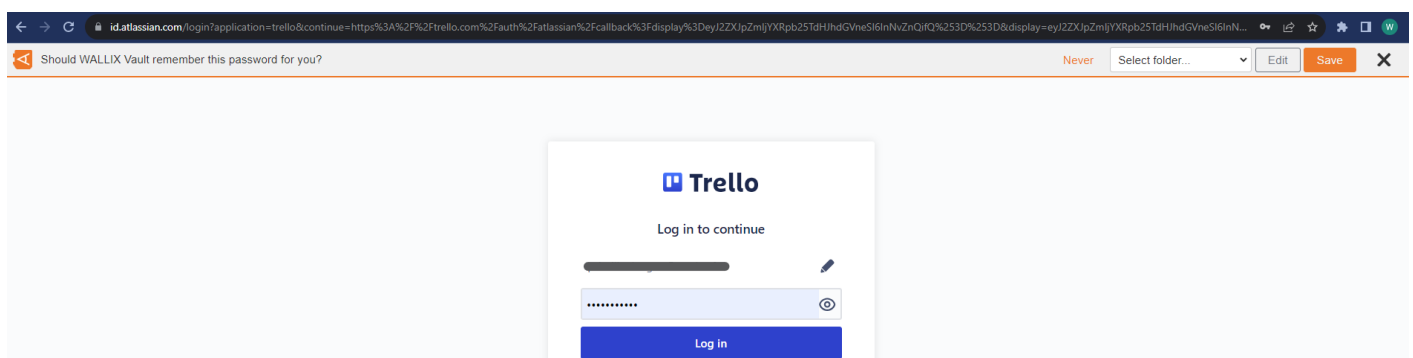

Choose a **Folder** to add the Login to this Folder in the Vault. This field is **optional**.

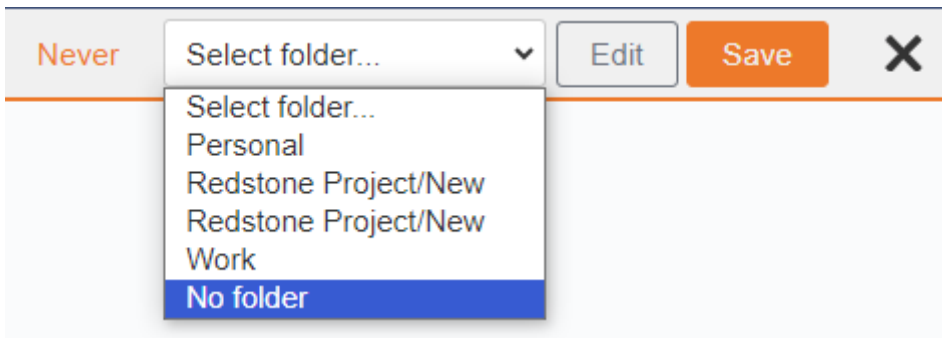
A screenshot of a user interface element. On the left, the word "Never" is displayed in orange. To its right is a dropdown menu with the text "Select folder..." and a downward arrow. The dropdown menu is open, showing a list of options: "Select folder...", "Personal", "Redstone Project/New", "Redstone Project/New Work", and "No folder". The "No folder" option is highlighted with a blue background. To the right of the dropdown menu are three buttons: "Edit" (light gray), "Save" (orange), and a close button represented by a black "X" icon.

Items are **added** to the **User's Individual Vault** and not a Shared Vault.

Click the **Save button**.

The **Add Item Screen** displays with the **fields pre populated** with the Login details.

Modify fields, if required.

Cancel

Add item

Save

ITEM INFORMATION

Type

Login

Name

id.atlassian.com

Username



Password

.....



Authenticator key (TOTP)



URI 1

https://id.atlassian.com/login?application=trello&contir



New URI

Auto-fill on page load (if set up in Options)

Use default setting



Folder

No folder



Favorite

☐

Master password re-prompt

☐

Notes

CUSTOM FIELDS

⊕

New custom field

Text

OWNERSHIP

Who owns this item?

Click **Save** to Save Item to Vault.

Alternatively, click **Cancel** to cancel the operation.

Auto-fill Manually

You can **manually add** a **Login** that is **not** already in the **Vault**.

From the **Vault Screen** of the **Browser Extension**, click **Add a login**.

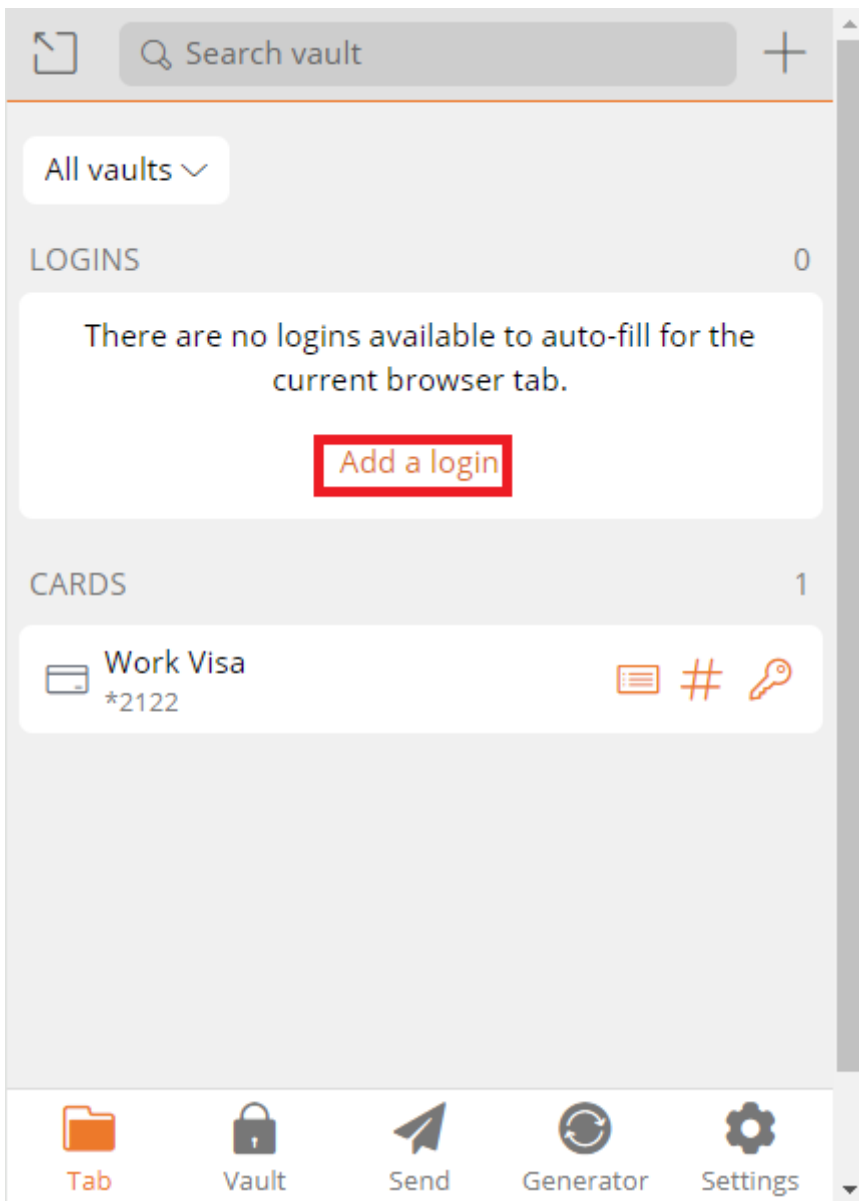

The **Add Item Screen** opens.

The **elements** that the Browser Extension could **recuperate** from the **browser** are **prepopulated**.

Cancel Add item Save

ITEM INFORMATION

Type
Login

Name
multimedia

Username

Password

Authenticator key (TOTP)

URI 1
https://multimedia

+ New URI

Auto-fill on page load (if set up in Options)

Enter the **remaining fields**. Click **Save** to create Login.

Alternatively, click **Cancel** to cancel the operation.

Auto-fill using Keyboard Shortcuts

Use the following **default keyboard shortcuts** (also known as **hot keys**) to auto-fill a login.

- Use Ctrl + Shift + L if running Windows or Linux
- Use Cmd + Shift + L if running for macOS

If **multiple logins** are found for the URI, the **last-used login** is used for auto-fill.

Keyboard shortcuts can be useful to **populating multiple logins** in **rapid succession**.

Configure shortcuts: If the keyboard shortcut doesn't work, it may be because **another app** is already **using it**. Either remove the shortcut from the other app or configure WALLIX to use a different shortcut.

TOTP Copy

If the Login uses **WALLIX Authenticator** for TOTP, the shortcut also **copies** the **TOTP** to the clipboard after auto-filling the web page with any of the above methods.

Auto-fill for iframes

Auto-fill does **not work** for untrusted iframes.

An untrusted iframe is **defined** as one where the **src** value is **not** the **same** as the **URI** for the **Login** item, as required in the rules set for **Match Detection Behavior**.

When the browser extension detects an iframe it responds based on the type of auto-fill being used:

- **Auto-fill on Page Load:** the browser extension disables the auto-fill on page load and does not warn the user
- **Auto-fill using Context menu, Keyboard Shortcut or from Browser Extension:** the browser extension warns the user about the iframe.

Revision #35

Created 4 December 2023 15:07:13 by WALLIX Admin

Updated 6 January 2025 19:32:43 by WALLIX Admin