

Change Language

By default, WALLIX Enterprise Vault uses the language of the Web Browser.

To change the language of the screens in WALLIX Enterprise Vault, click on the **Account Settings** button in the User Menu.

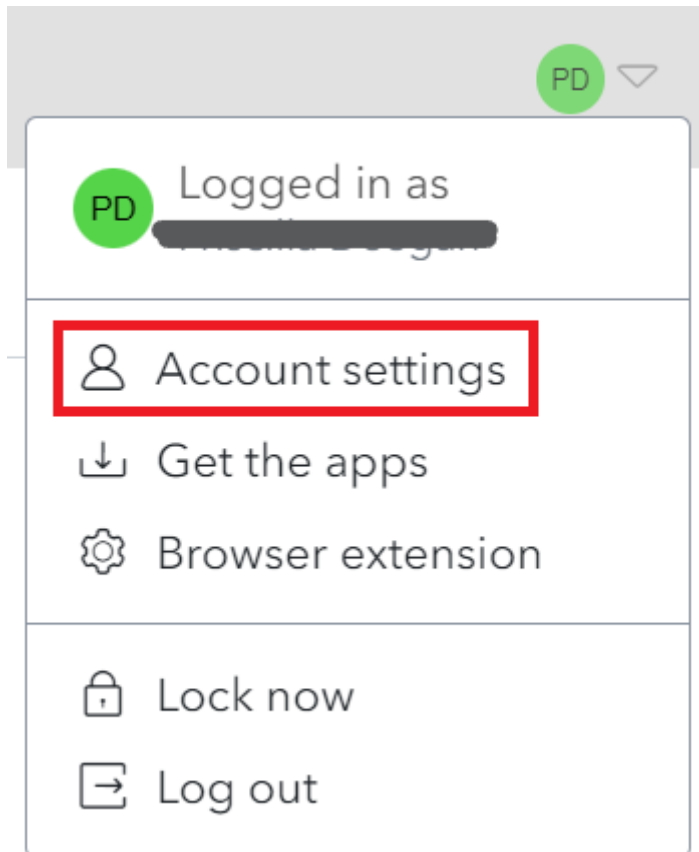

This opens the **Preferences** Screen.

Choose the language from the **Language** dropdown menu.

Click the **Save** button to save the user interface language.



ACCOUNT SETTINGS

My account

Security

Preferences

Domain rules

Preferences

Customize your web vault experience.

Vault timeout

15 minutes

Choose when your vault will take the vault timeout action.

Vault timeout action

☒ Lock

Master password or other unlock method is required to access your vault again.

☐ Log out

Re-authentication is required to access your vault again.

Language

en - English

Change the language used by the web vault.

☒ Show website icons

Show a recognizable image next to each login.

☐ Display full width layout

Allow the web vault to expand the full width of the browser window.

Theme

Light

Choose a theme for your web vault.

Save

Supported Languages

The following list of languages are currently supported.

Note: Not all languages are supported on all client applications.

Symbol	Language
af	Afrikaans
az	Azərbaycanca
be	Беларуская
bg	български
ca	català
cs	čeština
da	dansk

Symbol	Language
de	Deutsch
el	Ελληνικά
en	English
en-GB	English (British)
eo	Esperanto
es	español
et	eesti
fa	فارسی
fi	suomi
fr	français
he	עברית
hi	हिन्दी
hr	hrvatski
hu	magyar
id	Bahasa Indonesia
it	italiano
ja	日本語
ko	한국어
lv	Latvietis
ml	മലയാളം
nb	norsk (bokmål)
nl	Nederlands
pl	polski
pt-BR	português do Brasil
pt-PT	português
ro	română
ru	русский
sk	slovenčina
sr	Српски
sv	svenska
th	ไทย
tr	Türkçe

Symbol	Language
uk	українська
vi	Tiếng Việt
zh-CN	简体中文
zh-TW	繁體中文

Revision #4
Created 6 November 2023 13:41:35 by WALLIX Admin
Updated 6 January 2025 19:32:43 by WALLIX Admin