

Move Item to Shared Vault

From the **Item List** click the **More Button** of an **Item**.

The Shared Vault Item **Context Menu** is displayed.

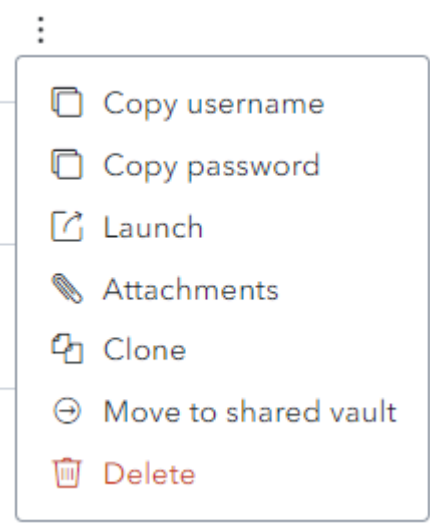

Click **Move to Shared Vault**.

The following screen is displayed.

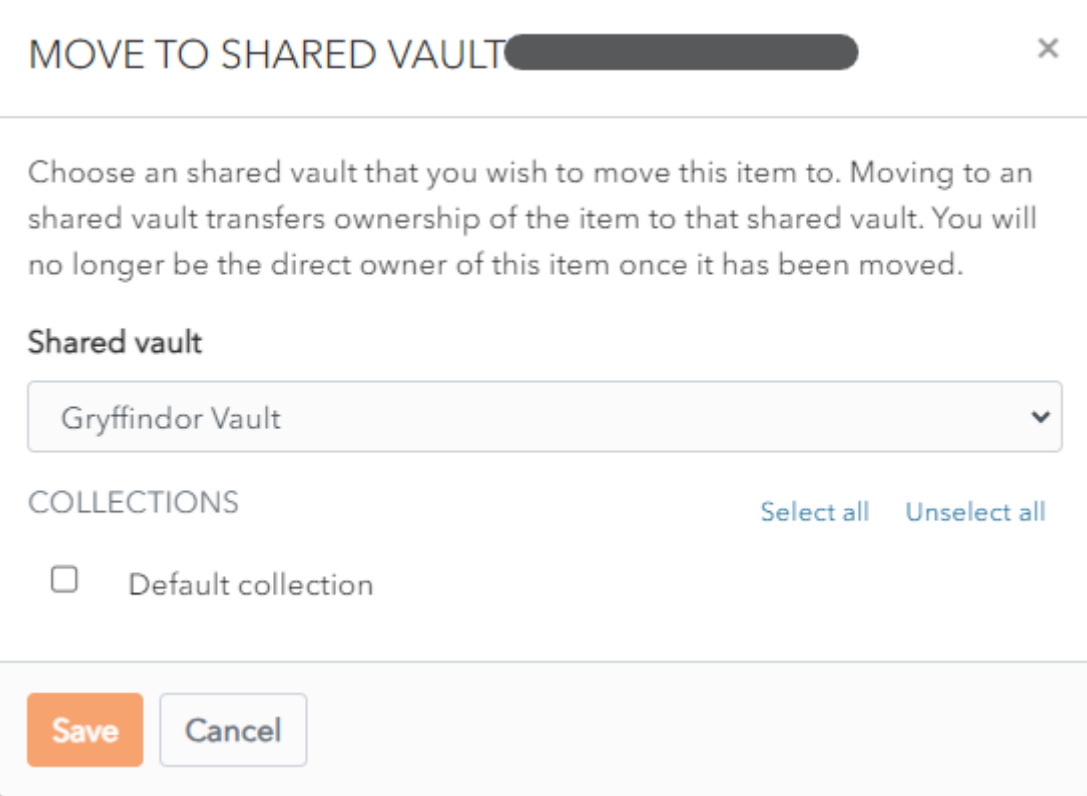

From the **Shared Vault** dropdown, choose the Shared Vault to move the Item to.

In the Collection section, the **list of Collections** in the Shared Vault is displayed.

Check the checkbox beside the **Collections** to **add the Item to**.

Click **Save** to move the Item to the chosen Shared Vaults and Collections.

Click **Cancel** to cancel the operation.

Revision #2

Created 13 December 2023 16:59:29 by WALLIX Admin

Updated 6 January 2025 19:32:42 by WALLIX Admin